

LK11A SERIES

1 passages Pneumatic Rotary Union

LK11a series single channel rotary joint, interface size G1 / 8 ", compact structure, light weight, corrosion resistance, stainless steel shaft and aluminum shell All LK series models are equipped with male thread shaft and female thread shell as standard for easy installation.

Product images



The pictures are for reference only

As the signal pathway increases or the combination of light and electricity results in changes in the appearance and size of the product, the actual product shall prevail.

Part# Explanation

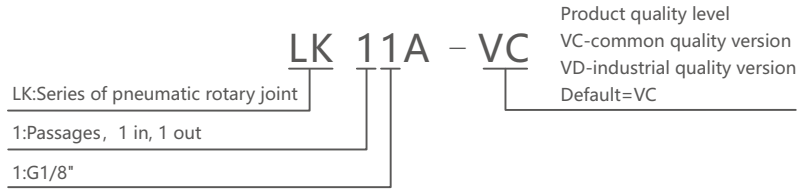

Dimensions

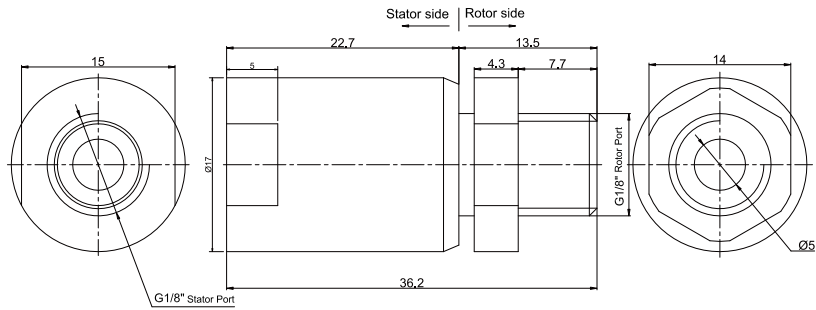

LK 11A Series Parts# List

Part#	Port Size	Port Size	Pressure
LK11A	1 in 1 out	G1/8"	80KPa, Vacuum

Mechanical Data

Parameter	Value
Working life	Please see the product quality level table
Rated Rotating Speed	Please see the product quality level table
Working Temperature	-30°C~80°C
Operating Humidity	0~85% RH
Sealing Element	Please see the product quality level table
Housing Material	Aluminum alloy / steel
Protection Grade	IP51

Rotary Joint Data

Parameter	Value
Passage	1 Passage
Max Pressure	Vacuum-80KPa
Dielectric medium	Air, Vacuum
Torque	Related to the connection size, please see the product selection table

Product Quality Level Table

Products Level Code	Max Rotating Speed	Working Life	Sealing Element
VC	100RPM	6 Million Revs	Seals of domestic famous brand
VD	300RPM	20 Million Revs	Imported Sealing elemen

Options for custom slip ring

Note: Below special demands can be customized. According, the delivery date will be extended 3 to 15 days; also the cost will be increased 30% to 50%. Most of our basic parts are standard and modular, which can save the cost and lead time.