

BS1650 CAPSULE SLIP RINGS

BS1650 slip rings are small and compact with OD 25mm * L 85.7mm, with capsule style, standard, off-the-shelf. Color-coded lead wires are used on both the stator and rotor for simplified electrical connections. Using a 90° V-groove ring design for each ring.

BS16509 is the high-end version corresponding to BS1650, Ultra thick gold plating treatment, fully imported bearings, rare metal alloy brush wires, mainly used in non civilian fields such as military and national defense.

Product images



The pictures are for reference only

If there are changes in the appearance and size of the product, the actual product should prevail.

Part# Explanation



Dimensions

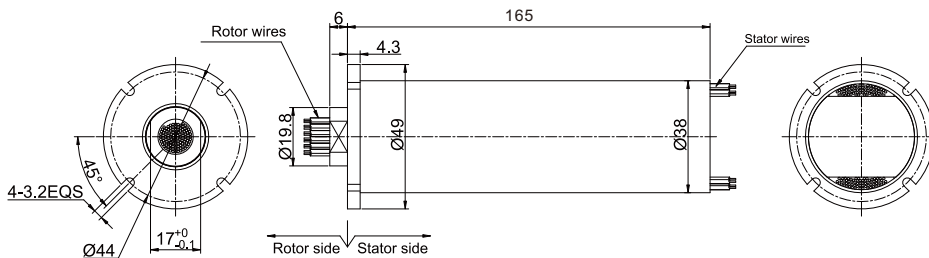

BS1650 Series Parts# List

Parts#	Signal/2A	4A	8A	15A	Total Wires
BS1650	84	0	0	0	84

Note: N channels 2A rings parallel can be used as 1 channel N × 2A current. For example: 2 rings 2A parallel could be used as 1 wires 4A ,please contact sales for special requirements

Product Quality Level Table

Part#	Max Speed	Working Life	Torque	Housing Material	Electrical Noise①@10RPM
BS1650	250RPM	10 million	0.02 N·m	Plastics	10mΩ
BS16509	600RPM	20 million	0.005 N·m	Metal	5mΩ

Electrical Data

Project	Numerical value	Signal
Rated Voltage	0~240VAC/VDC	0~240VAC/VDC
Insulation Resistance	≥100MΩ/500VDC	≥100MΩ/500VDC
Lead Wires	AWG28# teflon	AWG28# teflon
Lead Length	Standard 300mm(adjustable)	
Electrical Noise	<0.01Ω	

Mechanical Data

Project	Numerical value
Working Life	See Product Quality Level Table
Rotating Speed	See Product Quality Level Table
Working temperature	-30°C~80°C
Operating Humidity	0~85% RH
Contact Material	See Product Quality Level Table
Housing Materia	See Product Quality Level Table
Torque	0.05N.m; +0.01N.m/6rings
Protection Grade	IP51

Options for custom slip ring

1. BS16509 is the high-end version corresponding to BS1650.
2. Optional flange mounting.
3. Specified connectors and Heat-shrink tube.
4. Longer lead lengths available.
5. High temperature is optional.
6. Military Grade.